

We have these maps for any part of Manitoba, Saskatchewan and Alberta. Also mailing lists of all kinds. Write us for map making, mounting, draughting, etc.

Price \$1.00 Paper Copy

Price \$1.50 Cloth backed Copy. (Any number of Maps can be mounted in one piece making one large map.)

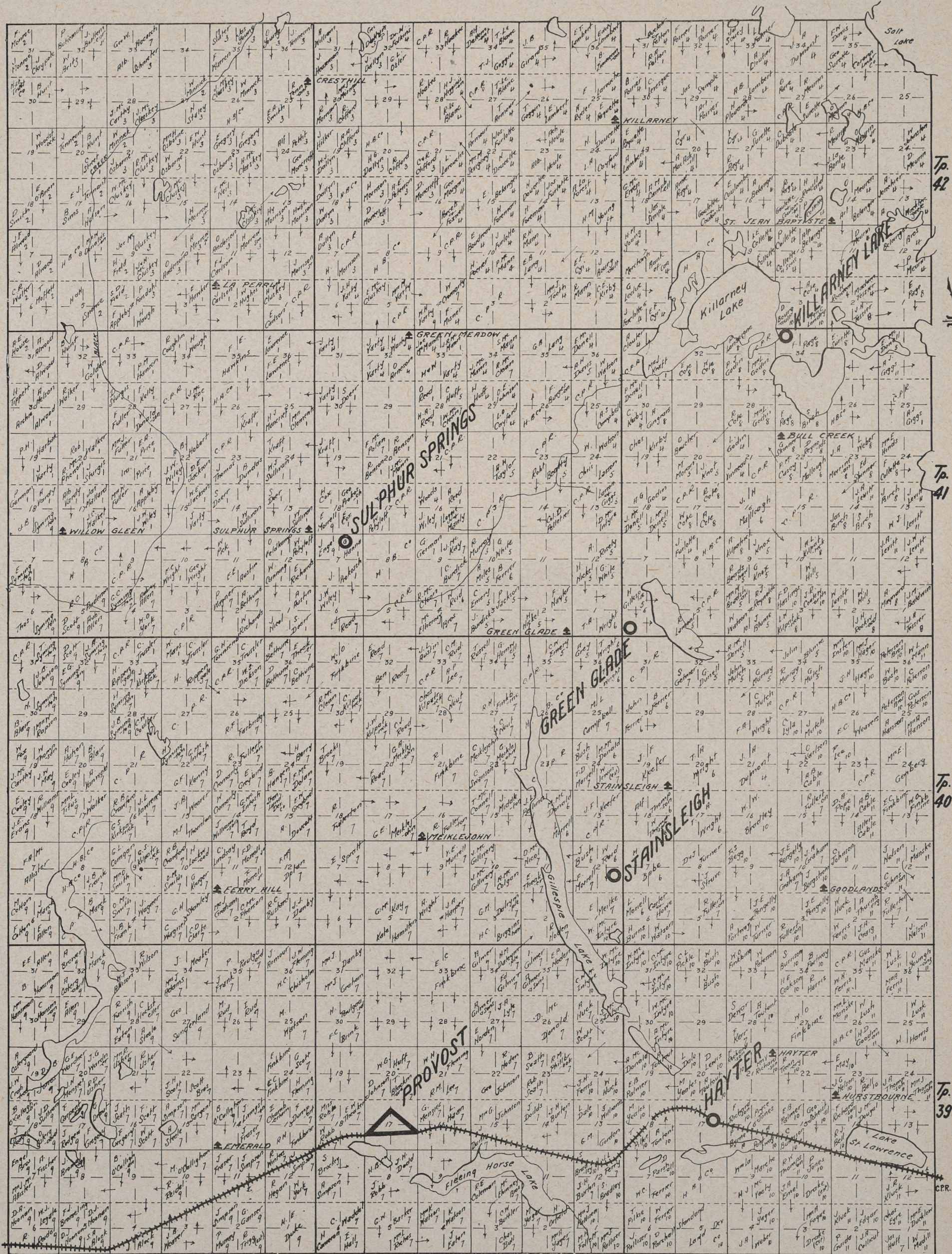

Tp. 42

Tp. 41

Tp. 40

Tp. 39

1. SULPHUR SPRINGS R. 3 3. RIBSTONE 5. GREEN GLADE 7. PROVOST R. 2 W. OF 4 M. 9. CADOGAN 11. HAYTER
 2. EDGERTON 4. CHARUVIN 6. STAINSLAIGH 8. KILLARNEY LAKE 10. HAYTER 12. HAYTER, SASK. R. 1 CUMMINS MAP CO. WINNIPEG, MAN. No 110

LEGEND: — ↑ Schools □ Cities □ Towns ▲ Villages ○ Post Offices ● Sidings
 Number below owners name refers to Post Office address, which follows same number at bottom of Map